

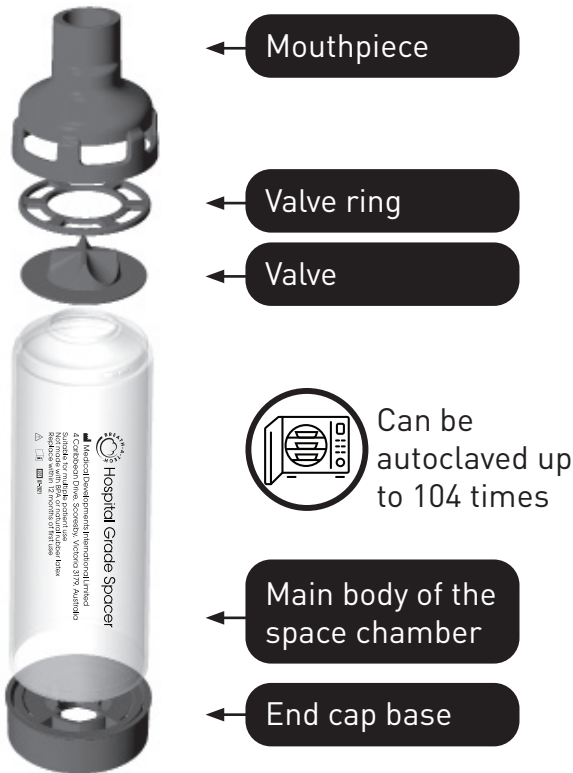

HOSPITAL GRADE SPACER

SUITABLE FOR MULTIPLE PATIENT USE

INSTRUCTIONS FOR USE



Medical Developments International Limited
 ABN 14 106 340 667
 4 Caribbean Drive, Scoresby Victoria 3179, Australia
 Telephone +61 3 9547 1888 Fax +61 3 9547 0262
 Email mdi@medicaldev.com
 Web www.medicaldev.com

9931MDI LI-BAT-HG-V1

Instructions for use

The Breath-A-Tech® Hospital Grade Spacer is a hand-held, portable valved holding chamber (VHC).

The spacer is placed between a pressurised metered dose inhaler (pMDI, or 'puffer') and the patient's mouth, to function as a reservoir from which aerosol medication is dispensed, in order to minimise the delivery of large aerosolised particles.

By holding the medication after aerosolisation, the spacer reduces the direct delivery of aerosolised particles into the mouth, which are intended for the lower airways. Suitable for adults and children to use with most standard puffers in the treatment of asthma and COPD.

The Breath-A-Tech® Hospital Grade Spacer can be autoclaved up to 104 times at 134°C for 3 minutes.

Suitable for multiple patient use. Not made with BPA or natural rubber latex.

⚠ WARNINGS

Ensure the instructions for use have been read prior to use and are kept available at all times. Always follow the instructions provided with your puffer. Children must be supervised by an adult or caregiver during use.

If breathing problems or symptoms persist, contact your physician and seek prompt medical attention.

Do not use the spacer if it shows signs of damage such as evidence of cracking, broken or deteriorated parts.

Check the spacer for foreign objects before each use. Store away from direct sunlight.

REPLACE WITHIN 12 MONTHS OF FIRST USE

Note: The Breath-A-Tech® Hospital Grade Spacer may be disposed of in general waste.

Ensure the spacer is cleaned and autoclaved between each patient use.

Replace the device immediately if there is any evidence of malfunction.

	1	2	3	4
	<p>Before using the Breath-A-Tech® Hospital Grade Spacer, it will need to be primed.</p> <p>Prior to priming, ensure the end cap base is removed by placing your thumb in the hole and pulling the end cap simultaneously.</p> <p>The Breath-A-Tech® Hospital Grade Spacer can be primed by depressing the puffer medication 6 times into the spacer to coat the main body of the space chamber.</p> <p>Attach end cap base to the main body of the space chamber prior to use.</p>	<p>Ensure the dust cap from the puffer has been removed. Push the puffer into the end cap base of the Breath-A-Tech® Hospital Grade Spacer.</p>	<p>Put the spacer mouthpiece between your lips and make an airtight seal.</p> <p>Depress the puffer and you will see a fine spray inside the Breath-A-Tech® Hospital Grade Spacer.</p> <p>Breathe in and out through the spacer for 4-6 breaths or follow the instructions provided with your puffer, or as directed by your healthcare professional.</p> <p>⚠ Always follow the instructions provided with the puffer or your asthma/COPD action plan on how long to wait before repeating this step. Only use one dose from the puffer at a time.</p>	<p>If a face mask is required, it is recommended that a MyMDI small, medium or large silicone face mask is used with the Breath-A-Tech® Hospital Grade Spacer.</p> <p>Firmly attach the silicone face mask to the mouthpiece of the spacer and place mask over your mouth and nose.</p> <p>Ensure the connection is secure at all times for an effective seal.</p> <p>Complete step 3, once a silicone face mask has been connected to the Breath-A-Tech® Hospital Grade Spacer.</p>



HOSPITAL GRADE SPACER

SUITABLE FOR MULTIPLE PATIENT USE

INSTRUCTIONS FOR CLEANING AND AUTOCLAVING

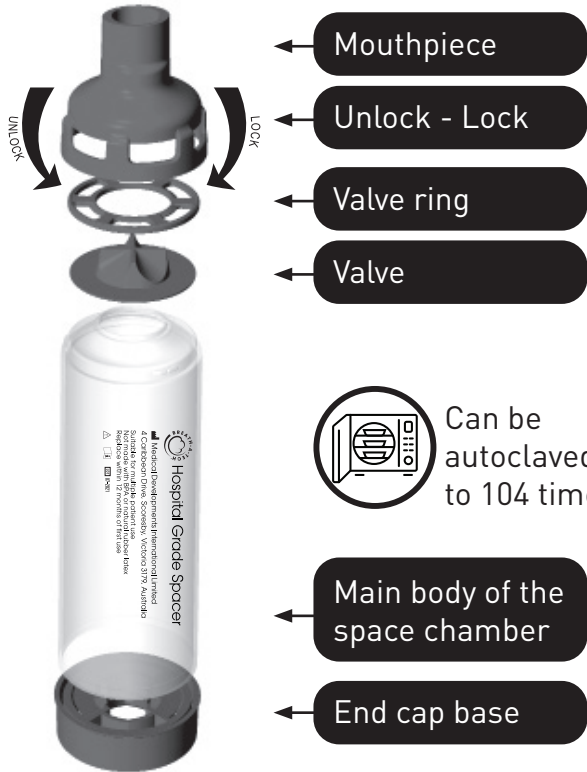

Cleaning Instructions

Step 1	Step 2	Step 3	Step 4
Remove the end cap by placing your thumb in the hole and pulling the end cap simultaneously. Disassemble all components including the mouthpiece, valve ring and silicone valve.	Carefully wash all components in clean warm water with a mild liquid detergent.	Do not rinse off the detergent residue. Shake off any excess water. Allow to air dry. Do not rub dry with a towel or cloth.	Reassemble the Breath-A-Tech® Hospital Grade Spacer as illustrated on the left hand side of this leaflet. Prime before use.

Autoclaving Instructions

Step 1	Step 2	Step 3	Step 4	Step 5
Prior to autoclaving, ensure Breath-A-Tech® Hospital Grade Spacer is disassembled and all components are rinsed thoroughly with clean warm water to remove any soapy residue from detergent. (refer to the cleaning instructions above).	Always follow the autoclave manufacturer's instructions for use. Ensure the temperature in the autoclave does not exceed 134°C. The Breath-A-Tech® Hospital Grade Spacer can be autoclaved up to 104 times for 3 minutes.	Place and seal Breath-A-Tech® Hospital Grade Spacer in a Self Seal Pouch (e.g. M+GUARD Self Seal Pouch 190*330) to ensure the spacer does not come into contact with the metal part of the autoclave.	Do not place other objects on top of the Breath-A-Tech® Hospital Grade Spacer in the autoclave. Autoclave at 134°C for 3 minutes. The recommended cooling time after autoclaving is 30 minutes.	Reassemble the Breath-A-Tech® Hospital Grade Spacer as illustrated on the left hand side of this leaflet. Ensure the mouthpiece is clicked securely into place and all components have been assembled. ⚠ Check that valve moves when fully assembled. ⚠ Check valve for damage before assembled Prime before use.



Medical Developments International Limited
 ABN 14 106 340 667
 4 Caribbean Drive, Scoresby Victoria 3179, Australia
 Telephone +61 3 9547 1888 Fax +61 3 9547 0262
 Email mdi@medicaldev.com
 Web www.medicaldev.com

9931MDI LI-BAT-HG-V1

Symbols	Manufacturer	Batch code	Catalogue number	Consult instructions for use	Caution
---------	--------------	------------	------------------	------------------------------	---------